



102 Ryde Road Gladesville NSW

5 🛏 5 🚿 2 🚗

This impressive luxury home combines flawless architectural design with modern interiors and an abundance of natural light throughout. Perfectly positioned in a prime location, between Boronia Park Village Shops and esteemed schools, with convenient access to Top Ryde Shopping Centre and transport links.

Type : Semi Detached

View : <https://www.eliasproperty.com.au/lease/nsw/north-hern-suburbs/gladesville/residential/semi-detached/8274422>

Property Features:

- * High Ceilings with ample natural light throughout
- * Ducted air conditioning throughout, designer tiles downstairs & Oak flooring upstairs
- * Designer kitchen with gas cooking, dishwasher, butlers pantry, stone island breakfast bar & ample cupboard space

[For full version visit the website](https://www.eliasproperty.com.au)



Nadim Wehbe
0425 339 166



Elly Khanpour
0455024269

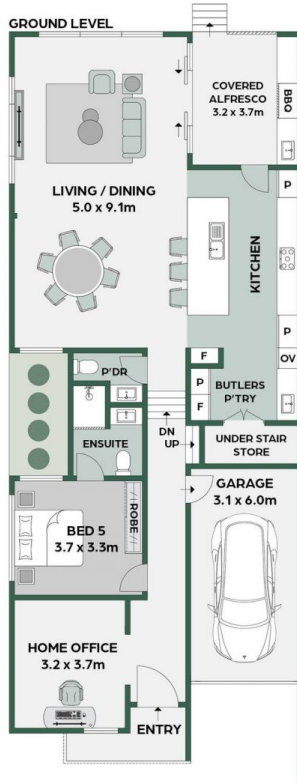
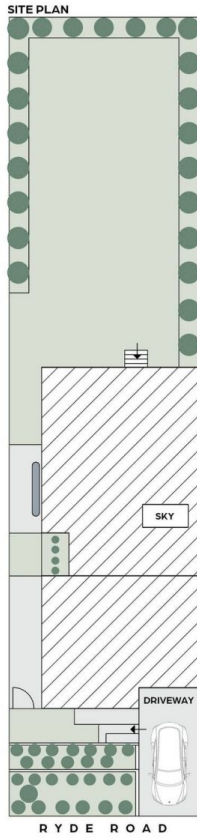

APPROXIMATE AREAS	
Ground Floor	160 sqm
First Floor	151 sqm
Total Internal Area	311 sqm
Land	453 sqm

102 Ryde Road, Gladesville

Plan provided by Continuous Creative. Scale in metres. Plan is indicative only and all dimensions are approximates. All information contained here is gathered from sources which are believed to be reliable and accurate. We cannot guarantee its accuracy and interested persons should rely on their own enquiries.