



26 Lavarack Street Ryde NSW

3 1 3

Set on a quiet street, this 1960's house presents a rare opportunity to develop a duplex property or place to call home. Enjoy the maintained character of this tightly held family home set on a 580.64 sqm block, and with unrestricted views at the rear, this property offers no shortage of space and opportunity. Just moments away from Smalls Road Public School, Macquarie Park, local shops and public transport, this location is perfect for any family.

- 580.64sqm block offering a rare duplex development opportunity (subject to DA approval)
- Flowing living and dining rooms with no shortage of natural light
- Double-sized bedrooms with built-in wardrobes
- Well-appointed bathroom with separate toilet

Land Size : 580.64 sqm

View : <https://www.eliasproperty.com.au/sale/nsw/northern-suburbs/ryde/residential/house/7983966>



Ella Elias
02 9807 3688



Annabelle Navybox
02 9807 3688



GROUND FLOOR

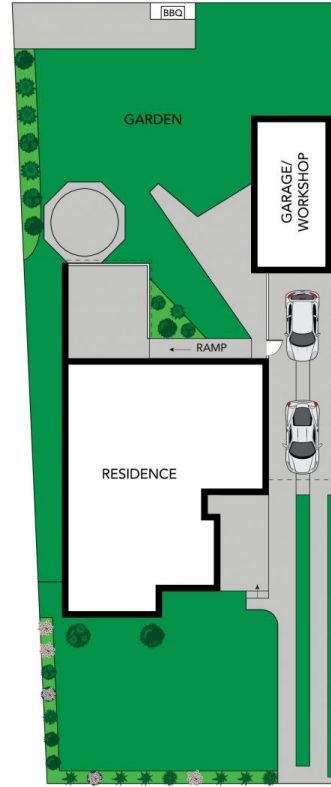

SITE PLAN (NOT TO SCALE)

INT: 86.8m²



Scale in metres. Indicative only. Dimensions are approximate. All information contained herein is gathered from sources we believe to be reliable. However, we cannot guarantee its accuracy and interested persons should rely on their own enquiries.

26 Lavarack Street, Ryde

