



602E/41-45 Belmore Street Ryde NSW

1 1 1

Featuring a generously sized bedroom and a modern bathroom, offering a perfect combination of elegance and comfort. The open-plan living area, along with a spacious study, creates a seamless space that's great for hosting guests, at home office, or a playroom.

View : <https://www.eliasproperty.com.au/sale/nsw/northern-suburbs/ryde/residential/apartment/7912316>

Nestled in a vibrant waterside neighbourhood, this apartment is located close to a picturesque riverside park and Ryde Wharf.

Within easy reach of city buses, the train station, shops, schools, and the Meadowbank Ferry.

- Open-plan living and dining area
- Covered entertaining balcony
- Stone kitchen fitted with modern gas cooking appliances
- Oversized study
- Light-filled bedroom with built-in wardrobes



Ella Elias
02 9807 3688



Annabelle Navybox
02 9807 3688

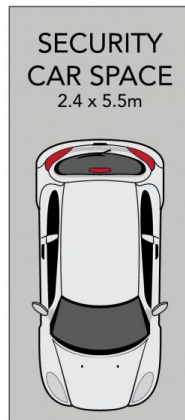
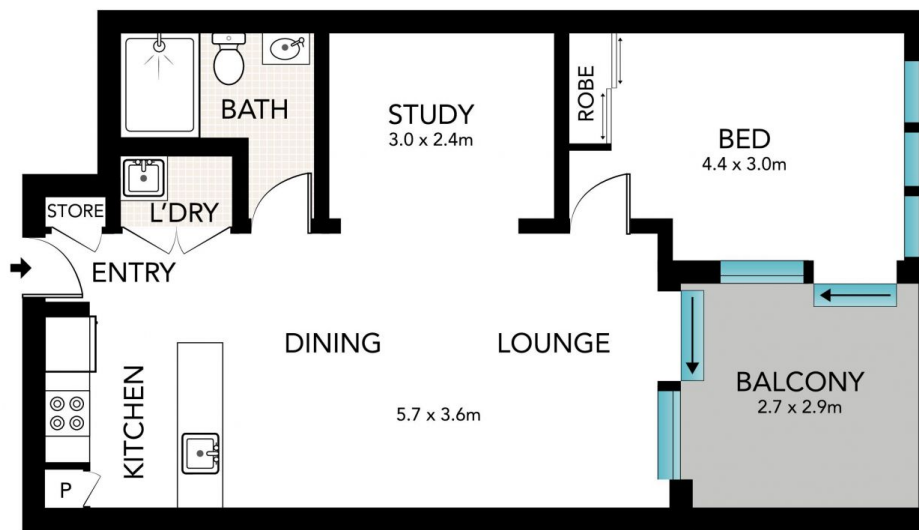

LEVEL 6



Scale in metres. Indicative only. Dimensions are approximate. All information contained herein is gathered from sources we believe to be reliable. However, we cannot guarantee its accuracy and interested persons should rely on their own enquiries.



602E/41 Belmore Street, Ryde

